

ILLUSTRATED SHOWING  
84888  
TYPE R  
ROTA-LIFT  
EASING GEAR

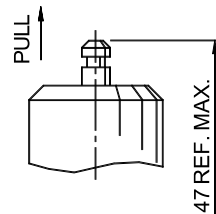

TYPE SL  
SPINDLE-LIFT  
EASING GEAR

## PARTS LIST & MATERIAL SPECIFICATION

		84888
1	BODY	ST.STL. BS EN 10088-3 1.4401 (316)
2	ELASTOMER SEAL	VITON
3	VALVE DISC	ST.STL. BS EN 10088-3 1.4401 (316)
4	SPRING	ST.STL BS EN 10270-3 1.4310 (302)
5	ADJUSTER	ST.STL. BS EN 10088-3 1.4401 (316)
6	SPINDLE	ST.STL. BS EN 10088-3 1.4057 (431)
7	NAMEPLATE	AL.ALLOY
8	CAP	ST.STL. BS EN 10088-3 1.4401 (316)

## APPROVALS

Ad - Merkblatt A2: (TÜV GERMANY) TÜV.SV.12-893.8.D/G.\*p\* = Variable  $\alpha_w$  below 3 Bar.g  
Designed in accordance with BS EN ISO 4126 & BS 6759.

P.E.D. 97/23/EC

Type examination module B, Cert No. 01202 111-B-00015

Quality management system module D, Cert. No. EDS 0002011/01

Meeting the requirements of the A.S.M.E. Boiler & Pressure Vessel Code section VIII for air/gas.

UV Cert. of Authorisation: 35757

Capacities certified by the National Board of Boiler & Pressure Vessel Inspectors.

## TECHNICAL DATA

Relieving pressure	= Set pressure +10%, (0.1 Bar.g below 1.0 Bar.g)
Reseating pressure	= Set pressure -10%, (0.3 Bar.g below 3.0 Bar.g)
Maximum set pressure	= 21 Bar.g
Minimum set pressure	= 0.55 Bar.g (3.0 Bar.g A.S.M.E.)
Flow area	= 50.27 mm <sup>2</sup>
Inlet bore diameter	= 8mm
Temperature range	= -15°C to 180°C
TÜV Derated coefficient of discharge $\alpha_w$	= 0.67 From 3 Bar.g. Below 3 Bar.g see graph.
NB Rated discharge coefficient $K_d$	= 0.748
Minimum lift at 10% overpressure	= 1.4mm

FOR FURTHER TECHNICAL INFORMATION, CONVERSION FACTORS, INSTALLTION AND OPERATING INSTRUCTIONS ETC. SEE TECHNICAL INFORMATION SECTION.



## SEETRU LIMITED

ALBION DOCKSIDE WORKS, BRISTOL. BS1 6UT  
TELEPHONE +44 (0) 117 927 9204, FAX +44 (0) 117 929 8193  
www.seetru.com enquires@seetru.com

8mm Nom. Bore ST.STL. CONSTRUCTION  
DIRECT SPRING LOADED ATMOSPHERIC  
DISCHARGE SAFETY VALVE FOR  
COMPRESSED AIR OR GASES.

SERIES E VALVE  
TYPE 84888, 84788, 84188  
ST.STL.

SHEET 1 OF 3 SHEETS

**FLOW CHART (P.E.D.)**

-TO CALCULATE INTERMEDIATE FLOWS SEE TECHNICAL INFORMATION SECTION

SET PRESSURE Bar.g	PRESSURE RANGE BELOW 3 BAR.G				PRESSURE RANGE ABOVE 3 BAR.G																
	0.55	1	2	3	3	4	5	6	7	8	9	10	11	12	13	14	15	17	21		
RATED DISCHARGE CAPACITY IN ACCORDANCE WITH BS EN 4126, AIR AT 15°C AND 1013 mbar Std.Litres/s	9	12	20	27	28	35	42	49	57	64	71	78	85	92	99	107	114	128	156		
RATED DISCHARGE CAPACITY IN ACCORDANCE WITH TÜV, AIR AT 0°C AND 1013mbar Normal m³/h	31.6	44.5	70.7	94.9	98.9	124.1	149.4	174.7	199.8	225.1	250.3	275.5	300.8	326.0	351.2	376.5	401.7	452	553		

BS CALCULATIONS ARE FOR GUIDANCE ONLY

**FLOW CHART (A.S.M.E.)**

SET PRESSURE Psig	44	50	60	70	80	90	100	110	120	130	140	150	200	250	300	305
RATED DISCHARGE CAPACITY IN ACCORDANCE WITH A.S.M.E. AIR AT 60°F AND 14.7 psia/scfm	67	74	86	98	110	121	133	145	157	168	180	192	251	309	368	373

**VALVE TYPE OPTIONS:**

- 84888 = TUV, B.S. (P.E.D.)
- 84788 = A.S.M.E. & N.B.
- 84188 = A.S.M.E. & N.B., TUV, B.S. (P.E.D.)

**VALVE SELECTION CHART**

#	INLET CONNECTION	ORDERING CODE	TOP FITTING CODE		DIM'N 'A' A/F HEX (mm)	INLET THR'D DIM'N 'L'
			R	SL		
#	G 1/4 (1/4" BSP PARALLEL)	84888 84788 84188	1213	0413	19.0	10
#	R 1/4 (1/4" BSP TAPER)		1223	0423		12
#	1/4" NPT		1233	0433		12
	G 3/8 (3/8" BSP PARALLEL )		1243	0443	20.6	10
	R 3/8 (3/8" BSP TAPER)		1253	0453		19.0
	3/8" NPT		1263	0463	15.3	
	G 1/2 (1/2" BSP PARALLEL )		1273	0473	24.0	12
	R 1/2 (1/2" BSP TAPER)		1283	0483		19
	1/2" NPT		1293	0493		19

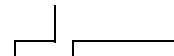

Example: Ordering code 84888 121 3 is a, Rota-lift type construction with 8mm bore, 1/4" BSP Parallel inlet connection and Viton® seals.

Note: Standard seal Viton®, other materials may be available.  
# = Max. tightening torque 14Nm.

SHEET 2 OF 3 SHEETS



**SEETRU LIMITED**  
ALBION DOCKSIDE WORKS, BRISTOL. BS1 6UT  
TELEPHONE +44 (0) 117 927 9204, FAX +44 (0) 117 929 8193  
www.seetru.com enquires@seetru.com

8mm Nom. Bore ST.STL. CONSTRUCTION  
DIRECT SPRING LOADED ATMOSPHERIC  
DISCHARGE SAFETY VALVE FOR  
COMPRESSED AIR OR GASES.

SERIES E VALVE  
TYPE 84888, 84788, 84188  
ST.STL.

PRESSURE/DISCHARGE CURVE FOR VALVE 84888  
0.55 - 3.0 BAR.G.

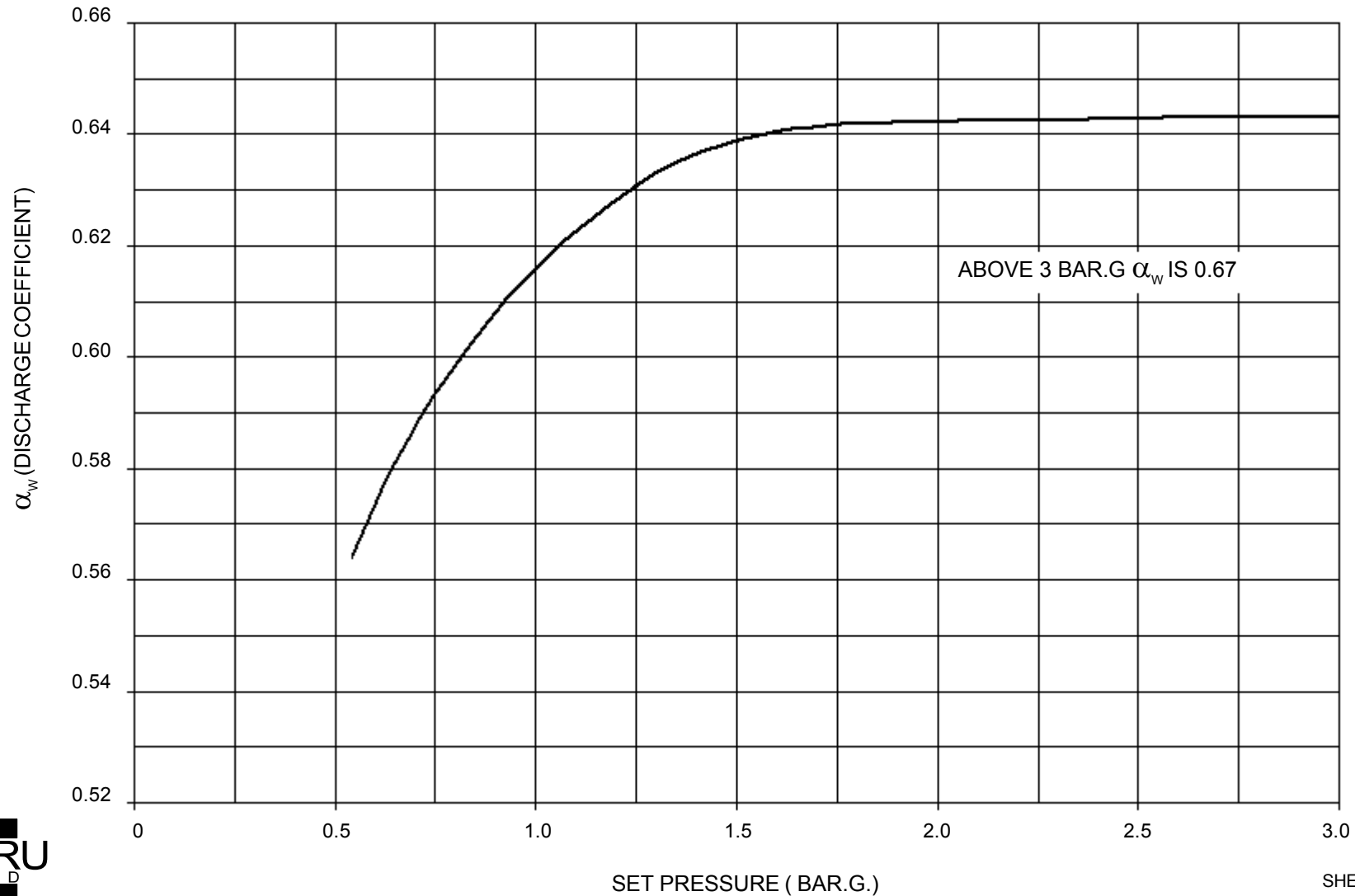

**SEETRU LIMITED**  
ALBION DOCKSIDE WORKS, BRISTOL. BS1 6UT  
TELEPHONE +44 (0) 117 927 9204, FAX +44 (0) 117 929 8193  
www.seetru.com enquires@seetru.com

8mm Nom. Bore ST.STL. CONSTRUCTION  
DIRECT SPRING LOADED ATMOSPHERIC  
DISCHARGE SAFETY VALVE FOR  
COMPRESSED AIR OR GASES.

SERIES E VALVE  
TYPE 84888, 84788, 84188  
ST.STL.

SHEET 3 OF 3 SHEETS